

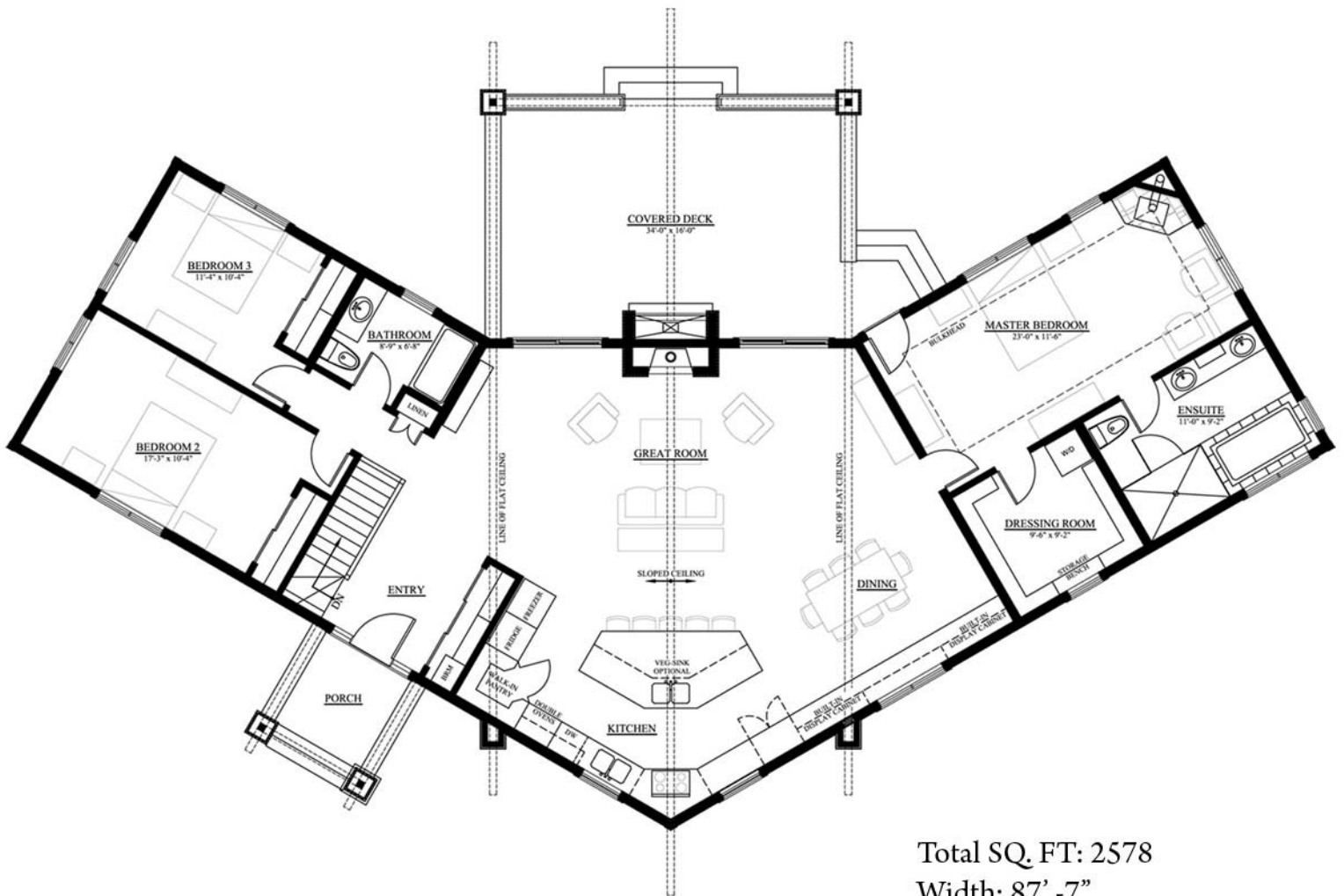

# The Southridge



## MAIN FLOOR PLAN

2039 SQ. FT

Total SQ. FT: 2578

Width: 87' -7"

Depth 48'-4"

Height 20-5 1/2" (Top

Ridge to U/S of floor system)





# The Southridge

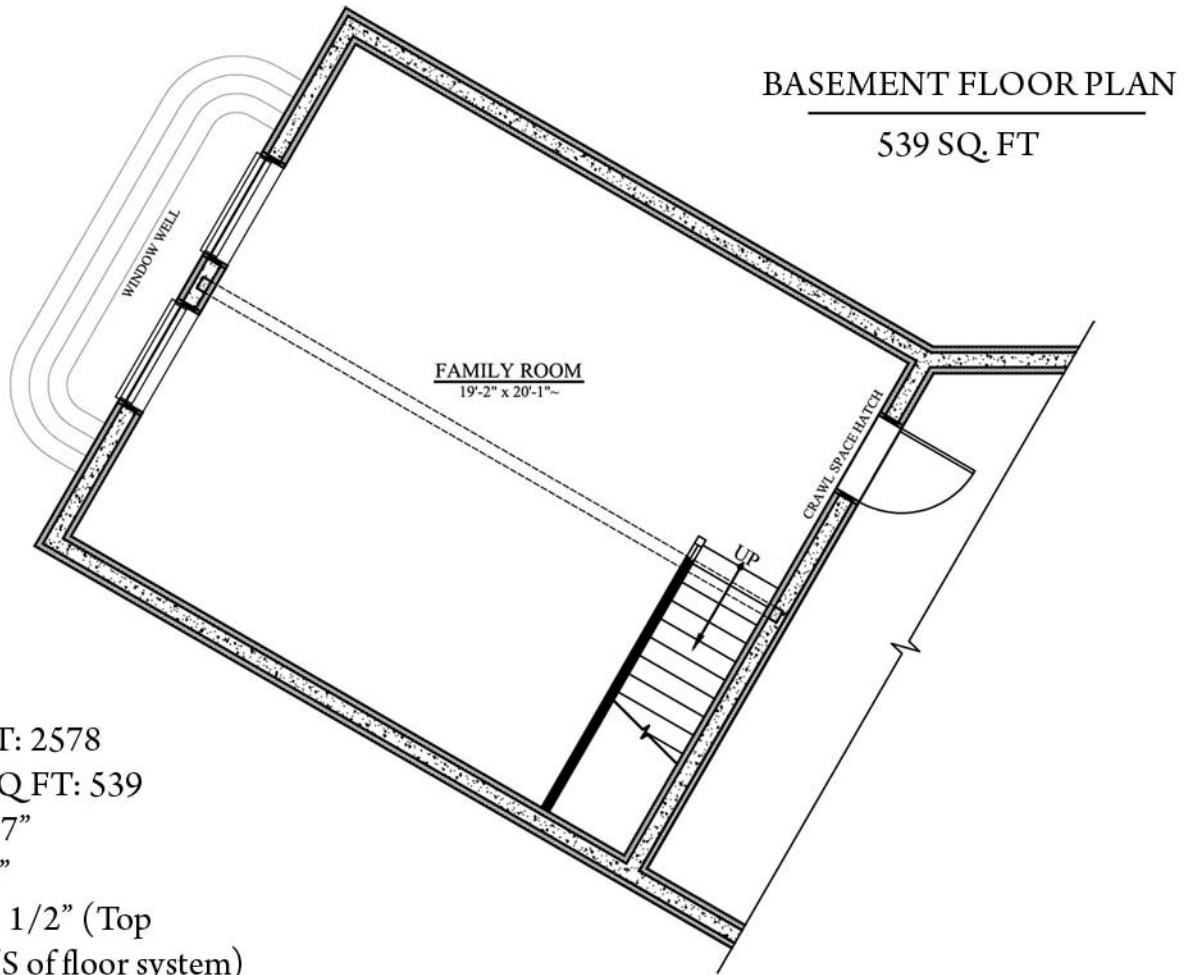

Total SQ. FT: 2578  
Basement SQ FT: 539  
Width: 87' -7"  
Depth 48'-4"  
Height 20-5 1/2" (Top  
Ridge to U/S of floor system)

